



# INSTRUCTION MANUALS

## SA-370 INTEGRATED STEREO AMPLIFIER

---

.....

**Notes on environmental protection:**

At the end of its useful life, this product must not be disposed off with regular household waste, but must be returned to a collection point for a recycling of electric and electronic equipment. The symbols on the product, user manuals and packaging point this out. The materials can be reused in accordance to their markings. Through re-use, recycling of raw materials or other form of recycling of old products, you are making an important contribution to the protection of our environment. Your local administrative office can advice you of the responsible waste disposal points.

.....

# CONTENTS

ACCESSORIES	3
CONTENTS	3
SAFETY PRECAUTIONS	4
IMPORTANT SAFETY INSTRUCTIONS	4
IMPORTANT INFORMATION	7
CONNECTIONS TO THE MAINS	8
REMOTE CONTROL	8
FRONT/REAR PANEL	10
AUDIO CONNECTIONS	11
OPERATION AND FUNCTIONS	12
ON, OFF and Standby	
Selecting the input source	
Using the function menu	
Volume control	
Bass and treble control	
Balance control	
Loudness	
TROUBLESHOOTING	15
TECHNICAL SPECIFICATIONS	16

# ACCESSORIES

## Accessories

- 1 x SA-370 Integrated Amplifier
- 1 x Remote control
- 2 x Batteries (Optional)
- 1x Optional volume knob
- 1 x Operation Manual

*This operation manual supplies all the information that you need to have about your System Fidelity Integrated amplifier. Please read this operation manual carefully before you start using the unit!*

## SAFETY PRECAUTIONS



A triangle with a lightning symbol draws the user's attention to "dangerous voltage" without insulation in the cabinet which may be high enough to entail a risk of electric shock.



A triangle with an exclamation mark draws the user's attention to important instructions for use and maintenance in the accompanying manual, which should be studied.



A symbol for CLASS II (double insulation)

### WARNING:

TO MINIMISE THE RISK OF FIRE OR ELECTRICAL SHOCK, DO NOT EXPOSE THE UNIT TO RAIN OR MOISTURE. DO NOT OPEN THE CABINET AS IT CONTAINS DANGEROUS VOLTAGE. ONLY QUALIFIED TECHNICIANS ARE ALLOWED TO CARRY OUT REPAIR AND SERVICE.

### CAUTION:

If the plug of the power cord needs to be replaced, it is important that the replacement is identical to the plug to be replaced, or that the new plug has been recommended by the manufacturer.

TO AVOID ELECTRICAL SHOCK, IT IS IMPORTANT TO INSERT THE PLUG CORRECTLY INTO THE SOCKET.

## IMPORTANT SAFETY INSTRUCTIONS

**WARNING:** IT IS IMPORTANT THAT YOU READ AND OBSERVE BOTH THE INSTRUCTIONS IN THIS MANUAL AND THE INSTRUCTIONS ON THE UNIT. KEEP THIS MANUAL FOR FUTURE REFERENCE .

This unit was designed and manufactured with a view to providing maximum safety for the user. Incorrect use of the unit may cause electrical shock or fire. The protection devices built into this unit will protect the user if the procedures below are observed in connection with installation, use and repair. This unit is fully electronic and contains no parts that can be repaired by the end user .

PLEASE DO NOT REMOVE THE CABINET. RISK OF DANGEROUS VOLTAGE. ONLY QUALIFIED AND AUTHORIZED TECHNICIANS ARE ALLOWED TO REPAIR THE UNIT.

### Read the manual upon unpacking the unit

Please read the manual carefully and observe all the instructions given.

### Power supply

Only the power supply indicated on the rating plate must be used for this unit.

If you are not sure which power supply you have, please contact the distributor or the local electricity supplier.

### Earthing or polarisation

If the plug cannot be inserted properly into the socket, or if the plug does not fit, the unit must not be used in your country.

**Ventilation**

The cabinet is provided with slots and openings to ensure ventilation and reliable operation and to protect the unit against overheating. Do not block or cover these openings. The openings must never be blocked, for instance by placing the unit on a bed, a sofa, a carpet or similar surface .

**Heat**

Do not place the unit near sources of heat such as radiators, heat registers, ovens or other units that produce heat.

**Water and moisture**

The unit must not be placed close to water, such as bathtub, wash basin, kitchen sink or laundry tub, in a damp cellar or close to a swimming pools, etc.

**Cleaning**

Unplug the unit before cleaning. Do not use liquid detergents and aerosol cleaning agents. Please use only a dry cloth for cleaning the unit.

**Power cords**

Wiring must be organised to prevent people from stepping on the cables and to avoid pinching by objects placed on or beside them. Take special care around sockets and plug boxes and where the power cords leave the unit.

**Overloading**

Make sure that wall sockets, extension cords and plug boxes are not overloaded as this may lead to fire or electrical shock.

**Lightning**

Unplug the unit for additional protection during thunderstorms or when the unit is not used for prolonged periods. This will prevent damage to the unit from lightning and power surges.

**Penetration of objects and liquid**

Never push any foreign objects through the openings into the unit, as they may touch dangerous voltage points or short-circuit parts and thus cause fire or electric shock. Do not allow any liquid to be spilled on or into the unit.

**Accessories**

Do not place the unit on unstable surfaces such as a trolley, stand, tripod, shelf or table. The unit may fall and injure children or adults or be seriously damaged. Use only trolley, stand, tripod, shelf or table that is very stable or provided with the unit. The unit must be installed in accordance with the manufacturers instructions and by means of installation equipment recommended by the manufacturer.

If the unit is placed on a trolley, the trolley must be moved very carefully. Sudden stops, unnecessary force and uneven surfaces may cause the trolley to turn over.

**Loads**

Do not place heavy loads on the unit and do not step on it. The load may fall and cause serious injury to persons or damage to the unit.

**Damage**

Unplug the unit and contact qualified technicians in the following cases:

- A) If the power cord or the plug is damaged.
- B) If liquid has been spilled on the unit or objects have fallen into the unit.
- C) If the unit has been exposed to rain or water.
- D) If the unit does not work properly after adhering to the instructions in the operation manual. Only the settings described in the operation manual

must be made as incorrect setting may result in damage and often will make it difficult for a qualified technician to make the unit work properly again.

E) If the unit has been dropped or damaged in any other way.

F) When the operation of the unit changes drastically, the unit requires service.

### Service

Do not attempt to carry out any service work yourself. By opening or removing the cabinet, you will be exposed to dangerous voltage or other hazards. Any service work should be carried out by qualified technicians.

### Spare parts

If spare parts are required, make sure that the service technician uses spare parts specified by the manufacturer or spare parts with the same characteristics as the original. Unauthorised spare parts may cause fire, electrical shock, etc.

### Safety check

After service or repairs on the unit, ask the service technician to carry out a safety check to ensure that the unit is ready for use.

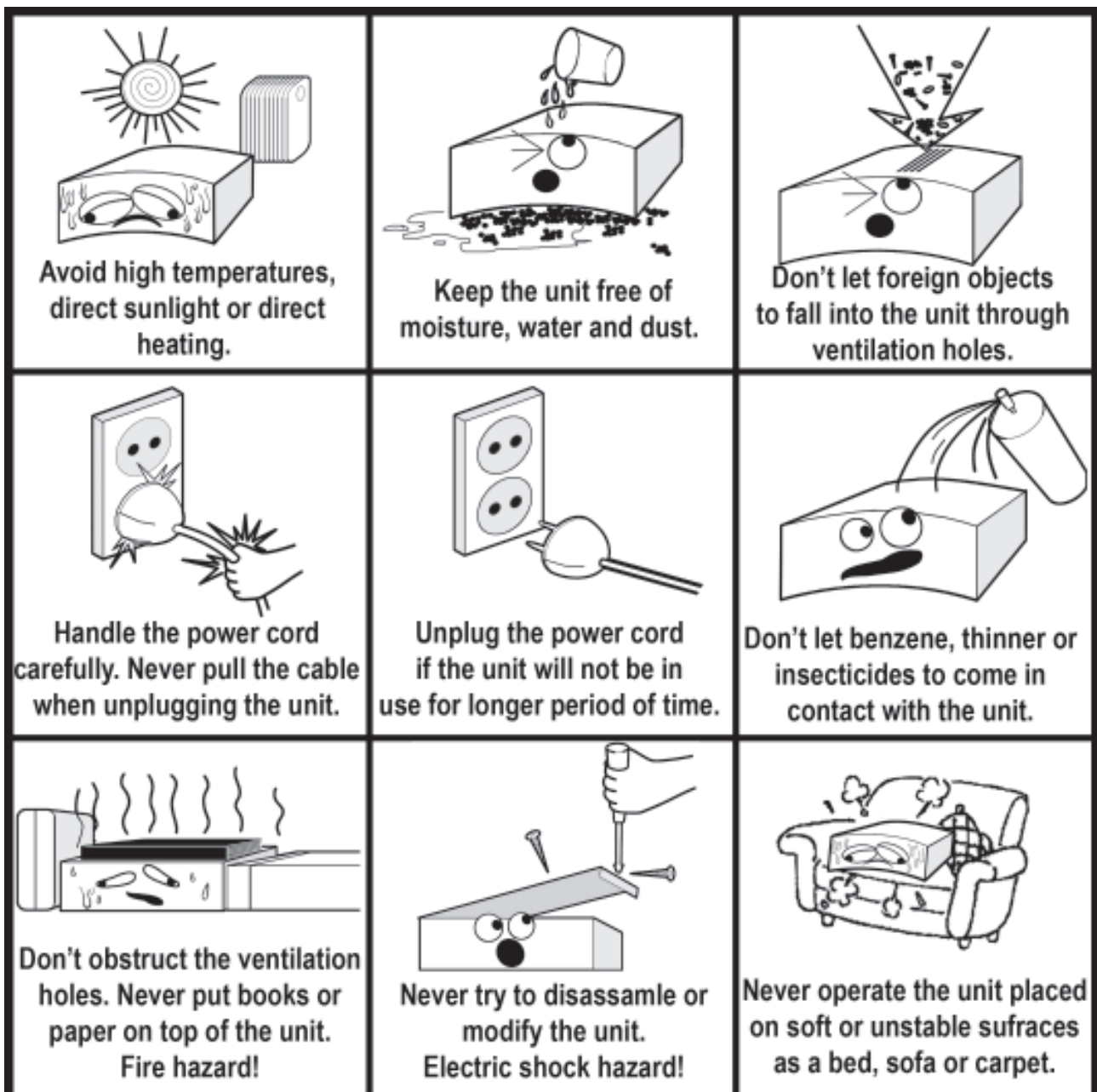

# IMPORTANT INFORMATIONS

## Handling instructions

The top and back panel of the unit may become warm after prolonged use. This is not due to a defect.

Turn off the power when the unit is not used.

## Protect the power cord

Follow the instructions below to prevent abnormal operation, electrical shock, fire or personal injury: Hold the plug firmly when inserting it into the socket.

Avoid heat-producing devices.

Do not place objects on the power cord.

Do not carry out service work on or change the power cord.

## Positioning

Do not place the unit in any of the following places:

- In sunlight, close to heat-producing devices or in an enclosed rack;
- In places with high temperatures (40C or more) or high relative humidity (90% or more);
- In dirty or dusty places as some internal parts may be damaged.

## Please do not put your fingers or any other objects into the unit

Touching the internal parts is dangerous and may cause injury or damage. Do not open the cabinet. Do not place any foreign matter in the unit.

## Interference

Placing the amplifier near a television set, radio or video player may cause poor picture and sound quality. In that case, move the amplifier further away from the television set, radio or video player.

## Condensation

Condensation may occur in the following cases:

When the amplifier is moved directly from a cold to a warm place.

When the amplifier is used in a room where the radiator has just been switched on or a place where the cold air from the air-conditioning system is directed at the unit.

If the amplifier is used in the summer in a warm and humid room just after it has been moved from an air-conditioned room.

If there is steam or a high level of humidity in the room.

In case of condensation, the amplifier will not work properly. Turn off the unit. Unplug the unit and leave it for 2-3 hours. The amplifier will then have adapted to the environment and any condensation will have disappeared.

## NOTES ON INSTALLATION:

*Your System Fidelity SA-370 should be placed on a firm, level surface. Avoid placing it in direct sunlight or near sources of heat and damp. Always allow adequate ventilation and don't place it on a soft surface like a carpet. Don't place it in an enclosed position such a bookcase or cabinet that may impede the air-flow through the ventilation holes. The unit shall not be exposed to dripping or splashing and that no objects filled with liquids, such as vases, shall be placed on the unit.*

## About connection to the mains

Do not turn on the power before all connections have been made correctly.

Check that all connections have been made correctly before turning on the power.

Check that the mains voltage is 230-240V AC50Hz before turning on the power.

Check that all other connections have been made correctly before inserting the mains plug into the wall socket.

Then insert the plug into a suitable socket.

If the unit is to be used abroad, you may need an adapter.

## REMOTE CONTROL

### Installation of batteries

Remove the cover at the back.

Position two batteries of the type AAA/R03/UM4 in the battery compartment. Make sure that the orientation and polarity of the batteries is correct (see drawing).

Do not mix new and old batteries and do not use different types of batteries. If the remote control is not used for prolonged periods, remove the batteries from the remote control to avoid corrosion.

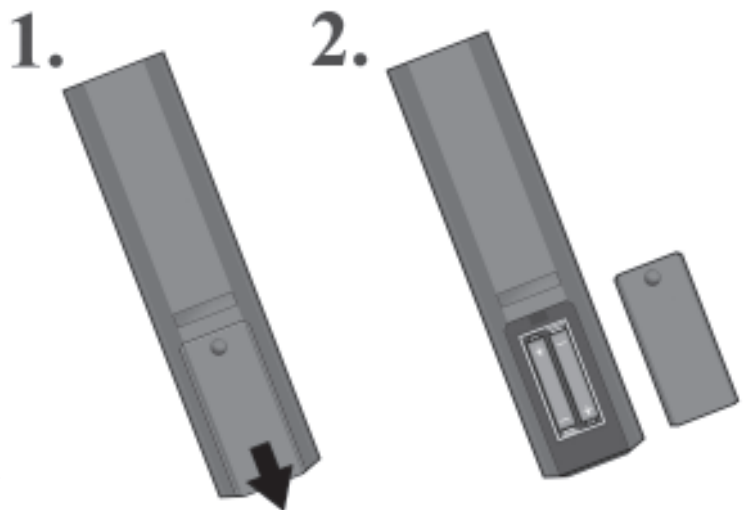

### Using the remote control

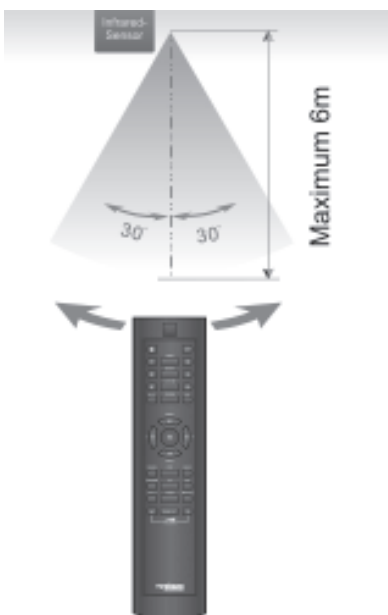

Direct the remote control at the sensor on the front panel of the amplifier. When the remote control signal is received, the unit reacts accordingly. The remote control works within a range of 6m.

Sometimes the remote control may not work well in direct strong light. You may have to move the amplifier if it is a problem.

Malfunction may occur if remote controls of some other equipments are used near the amplifier.

Do not place any objects on the remote control, as the batteries may become flat if a key is depressed constantly.

Make sure that there are no obstacles between remote control and amplifier.

Do not position the amplifier behind tinted glass as it may reduce the maximum range of the remote control.



# Remote control functions

## SA-370 AMPLIFIER FUNCTIONS:

- (1) Power: Sets the SA-370 into standby mode.
- (2) Light: switches on and off the light around the volume knob
- (8) Mute: temporarily switches off the sound.
- (20-24) Input buttons: Selects input source of amplifier.
- (24) SPKRS A/B: selects which pair of speakers are playing.
- (26) Volume +/-: Adjusts the master volume.

**Note:** Some of the amplifier functions can only be performed by means of the remote control. Some functions are connected with the selected signal input source. Some buttons on the remote control may therefore not be available if the corresponding signal input source has not been selected.

## ST-370 TUNER FUNCTIONS:

- (1) Power: Sets the ST-370 in standby mode.
- (4) AM/FM: press to choose between AM or FM mode
- (5) 1-6 : Directly selects the first six stored stations.
- (6) MEMORY: press to store the tuned station
- (7) Autotune: Press for automatic search in to AM/FM stations. At FM, the autotune function will search for a station at a higher frequency.
- (9) RDS: Displays RDS and other information.
- (10) ST/MONO: press to choose between stereo or mono reception (in case of very weak signal, mono can offer better sound without noise).
- (12-13) Tuning: press + or - for manual tuning.
- (14-15) P (preset): press + or - for selecting of the stored stations.

## CD-370 CD-PLAYER FUNCTIONS:

- (1) Power: Sets the CD-370 in standby mode
- (3) Eject: Opens the CD tray
- (5) 1-6 : Selects desired track for playback among first 6 tracks.
- (11) PLAY/PAUSE: press once for playback. If press during play, the disc is paused. Press one more time for resume play.
- (12-13) SEARCH (◀◀ / ▶▶): Search backwards or forward.
- (14-15) SKIP (◀◀ / ▶▶): Selects the previous or the next track.
- (16) Stop: Stops playback
- (17) Random: All tracks are played in random order
- (18) Repeat: Repeats a single track or all tracks on a CD
- (19) Program: Allows playback of the music tracks on a CD in a certain order

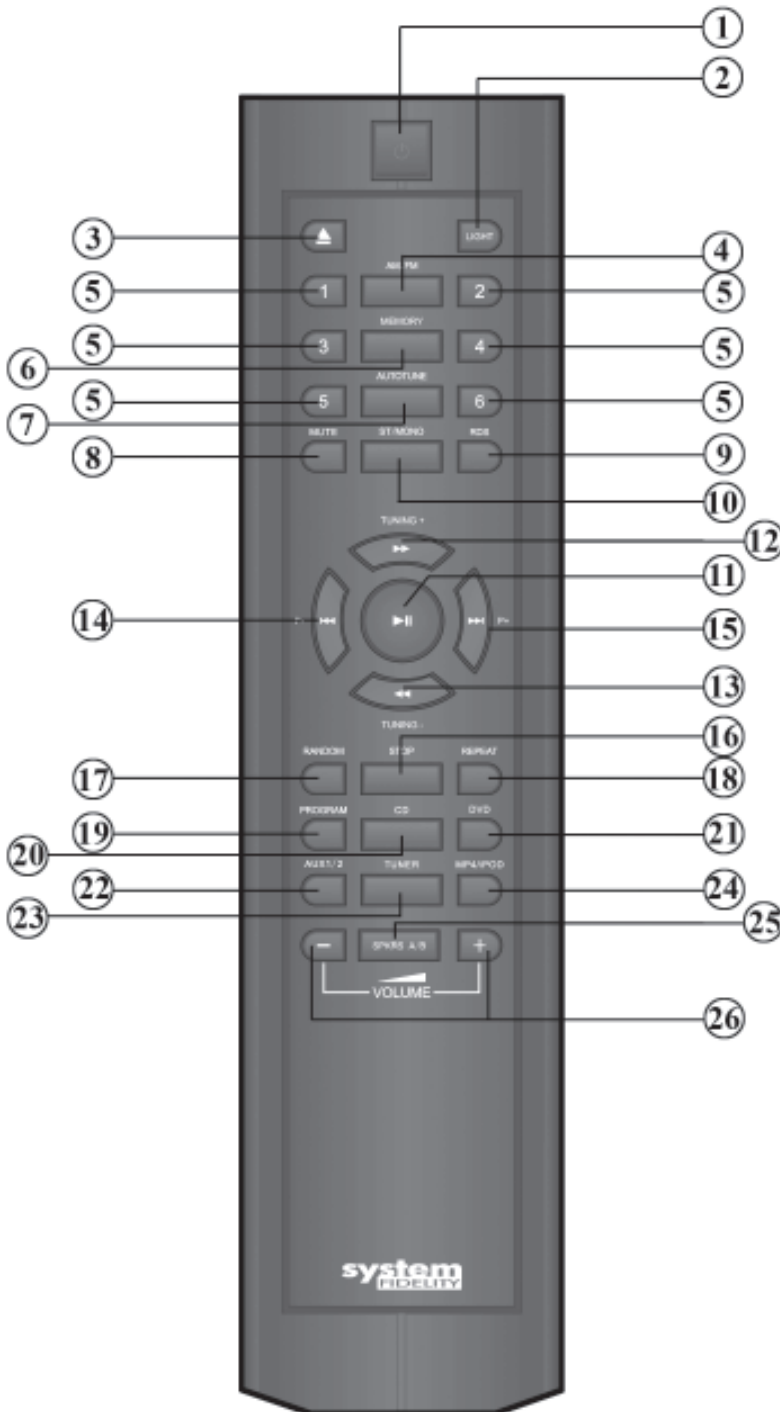

## FRONT PANEL DESCRIPTION

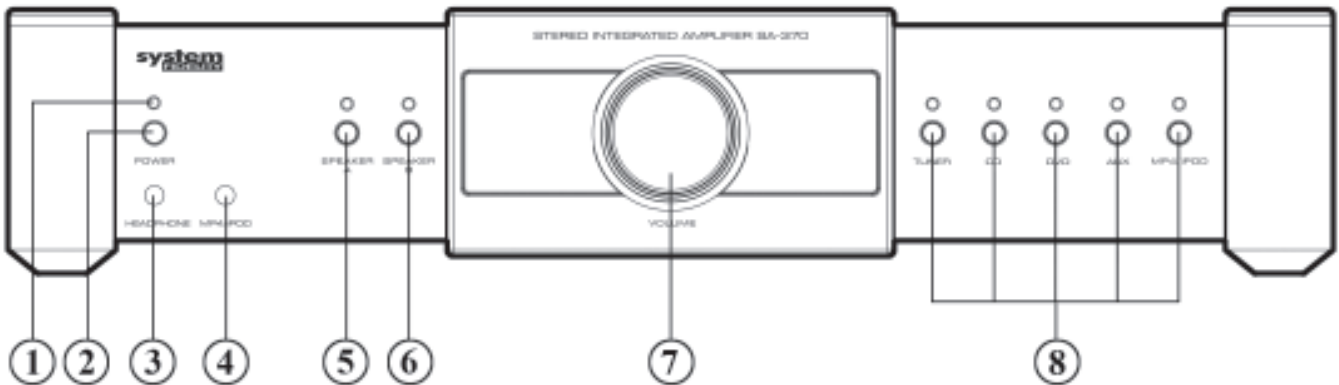

- (1) **LED indicator:** indicates the stand-by mode
- (2) **Stand-by power switch:** Used to switch the amplifier on and to stand-by.
- (3) **Headphone output jack:** 3,5-mm jack that suits most headphones.
- (4) **MP4/iPod input:** 3,5mm jack for connection of iPod or MP3 and MP4 player.
- (5) **Speakers A:** switches on or off the main speaker pair.
- (6) **Speakers B:** switches on or off the additional speaker pair.
- (7) **Volume knob:** by turning the knob sound volume increases or decreases.
- (8) **Input source selectors:** Activates the source input.

## REAR PANEL DESCRIPTION

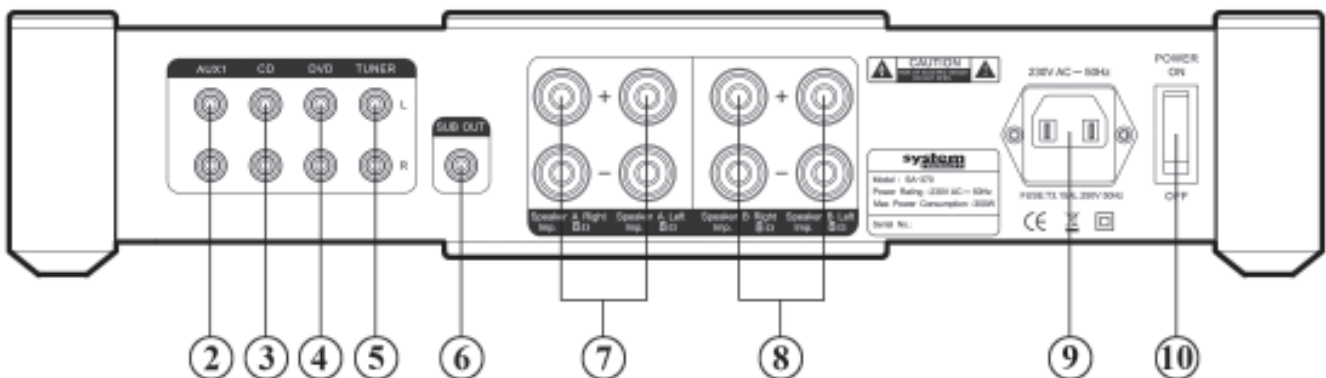

- (2) - (5) **Line Inputs** - RCA cynch inputs for connection of audio source units.
- (6) **SUB OUT:** RCA cynch output for connection of powered (active) subwoofer.
- (7) **Speakers A:** Speaker terminals (left and right speaker) for connection of the main speaker pair
- (8) **Speakers B:** Speaker terminals (left and right speaker) for connection of the additional speaker pair
- (9) **Power cord terminal:** for connecting the main lead.
- (10) **Main power switch:** The power on/off switch.

# CONNECTIONS

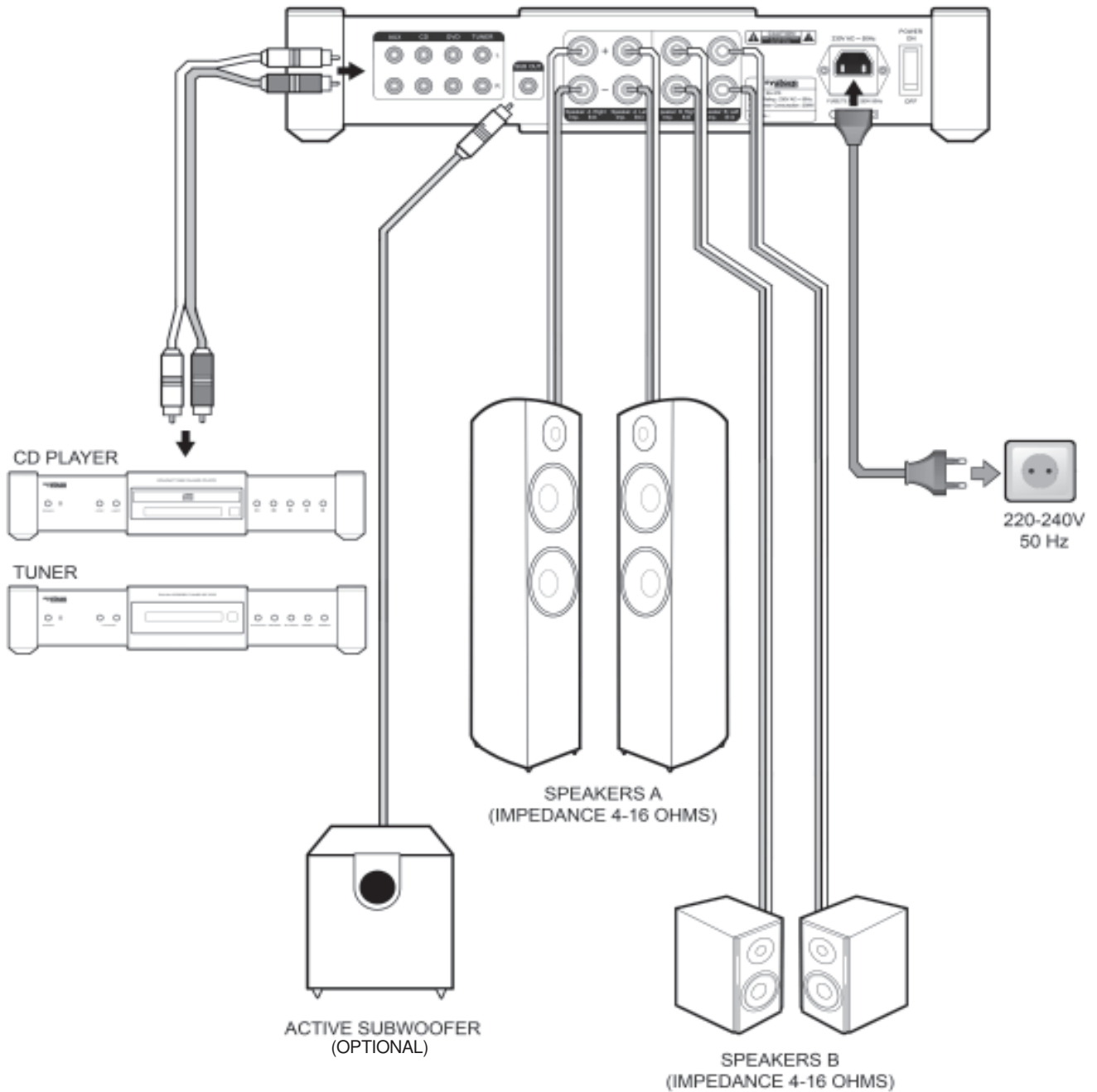

**IMPORTANT NOTICE: If you run two pairs of speakers simultaneously (A+B), then each speaker pair must have a minimum impedance of 8 ohms!**

1. Connecting speakers with bare cable

2. Make sure the terminal is tightly screwed

Optional: connecting speakers with 4mm banana connector

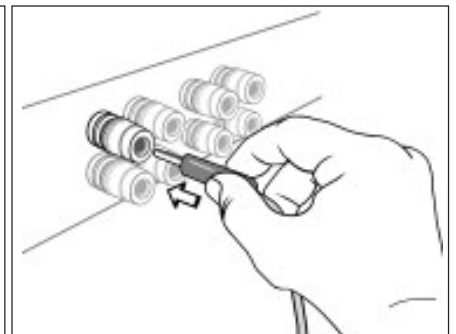
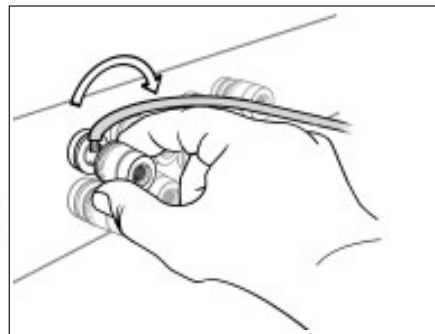
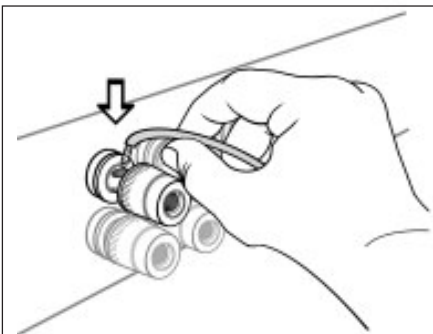

# OPERATION AND FUNCTIONS

## Quick start

1. Connect the speakers to the speaker terminals and sources to the relevant terminals and rear input sockets on the back panel of the unit.
2. Plug in the AC power cord.
3. Press the POWER switch on the back panel of the unit to turn the amplifier into stand-by mode.
4. Press the stand-by button on the front panel or on the remote control and press required input selector. And enjoy.

## On, Off and standby

1. By pressing the mains switch on the back panel turn the amplifier into stand-by mode. The red LED indicator on front panel will be lit. When in standby mode the unit only reacts to the standby button of the remote control or on the front panel.
2. Press the standby button on the remote control or front panel to switch on from standby mode. The stand-by red LED indicator will turn off.
3. If you wish to turn off the unit to avoid any power consumption, you must press the mains switch.

*Protect the environment and turn off the unit after use.*

## Connecting and selecting the input source

When making the connection, please refer to the connection diagram. Make sure that all the units are switched off during **any** connection. The RCA sockets on your SA-370 are color coded for your convenience. Red and white are RIGHT and LEFT audio respectively. Use high quality RCA-interconnect cables for optimum performance and reliability. Ensure that all cables and sockets are not damaged in any way and all sockets are firmly pushed home.

After finished connection turn on the SA-370.

Press the source input button to chose your desired input signal source. For example, CD button selects the CD-player (or other line-level source) connected to the CD-sockets as the active input; TUNER button for the connected tuner and so on. Red LED indicator at every button indicates which input source is active.

Release the input source button at your desired source, during this procedure we advice the volume to be decreased.

Please note, that SA-370 doesn't have a built in phono stage and corresponding input sockets. If you wish to connect a turntable to the amplifier, you should use some of the commercially available phono preamp-stages, which can be connected to any of the line input sockets. Contact your dealer about suitable phono stages for your amplifier.

**Note:** All inputs are **analogue** stereo inputs. It means that you cannot connect a digital sound source through a digital cable (optical or coaxial).

## Connecting and selecting the speakers

When making the connection, please refer to the connection diagram.

The speaker impedance must be between 4 and 16 Ohm. If two speaker pairs are connected and run simultaneously (A+B), the impedance of the speakers is recommended to be 8 ohms. For optimal sound quality there must be a proper and firm connection between the speaker terminals and the amplifier terminals. Ensure that all cables and sockets are not damaged in any way and all sockets are firmly pushed home.

Use high quality speaker cables for optimum performance and reliability. For speaker connection, you can use 4mm banana plugs, spads or bare wire according to your preferences. The cable ends must not be frayed to avoid that they come into contact with each other or the cabinet back panel. Be sure to connect the polarities of the speaker system and the speaker terminals correctly (+ to +, - to -).

After finished connection, switch the amplifier on.

Press the SPEAKERS A button on the front panel or remote control to chose the main speaker pair.

If you have connected additional pair of speakers, you can chose to listen to the main speakers (A), additional speakers (B) or both (A+B). When pressing button SPEAKERS A once, the red LED indicator will be lit and speakers connected to the speakers A terminals will be activated. If you press the SPEAKERS A button once again, the speakers A will be disconnected. When pressing button SPEAKERS B once, the red LED indicator will be lit and speakers connected to the speakers B terminals will be activated. If you press the SPEAKERS B button once again, the speakers B will be disconnected.

If you want to listen to the both speaker pairs at the same time, press both buttons A and B, so both LED indicators will be lit.

## Volume control

Turn the volume control knob to the right to increase the volume and turn the volume control to the left to reduce the volume.

The volume control on the front panel can be turned both clockwise and anticlockwise to change the volume. The volume control includes 64 steps, from -78,75 dB for minimum volume and up to 0 dB for maximum volume.

**Note:** *dB is a professional term for indicating the amplitude of an audio signal where 0 dB is the maximum output.*

## Remote control handset

By using the provided remote control handset the amplifier can be controlled remotely from your listening position. To use the remote control unit, point it towards the remote sensor beside the volume knob.

The remote controll handset handles all the functions of the SA-370 amplifier and performs the same functions as the buttons labeled the same on the front panel. Beside that, it is a multi-remote controll, which means it includes also buttons for remote controlling the functions of the CD-player CD-370 and the tuner ST-370 by System Fidelity.

**Note:** *the red lighted ring around the volume knob is not on the signal path and therefore it doesn't have any negative effect on the sound performance when it is lit. But if you wish to switch it off during listening, you can easily do so by pressing the LIGHT button on the remote controll. If you press that button once again, the red light ring will be lit again.*

## Optional volume knob

For maximum flexibility and and an opportunity for the user to make this amplifier customized, we're providing with the package an optional volume knob in different finish.

Depending on your visual preferences, you can use either of the volume knobs. Simply and carefully pull out the volume knob from the volume potentiometer axis and gently push the knob you prefer to the place.

The volume knob replacement doesn't have any effect on the amplifier performance, it is purely visual change.

## General

When you'll connect the amplifier into your hi-fi system for the first time, please note that as with most high quality electronics, it will require a burn-in time of few dozens of hours, until the full sound performance will be achieved.

Due to our taks for the maximum sound quality of this amplifier, we have omitted any filter stages or tone controls which are on the signal path and which can affect the sound.

If you wish to enhance the bass reproduction of your speaker sets, you can use any commercially available powered (active) subwoofer with a RCA output, which should be connected directly to the corresponding SUB OUT socket on the rear panel of the SA-370.

# TROUBLESHOOTING

PROBLEM	CAUSE/REMEDY
No power when the amplifier is turned on.	<ul style="list-style-type: none"> <li>-Switch on the electric current at the socket.</li> <li>-Check that the plug has been correctly inserted into the socket.</li> <li>-The internal fuse has blown and must be replaced</li> <li>-The power cord has been damaged and must be replaced</li> </ul>
No sound.	<ul style="list-style-type: none"> <li>-The amplifier has not been turned on from stand-by mode.</li> <li>-The volume control is set at a minimum</li> <li>-The speaker cables have not been correctly connected.</li> <li>-A wrong input source has been selected.</li> <li>-No input source has been connected.</li> </ul>
There is sound in one channel only.	<ul style="list-style-type: none"> <li>-The audio input cables have been incorrectly connected or damaged.</li> <li>-The input source is defective.</li> <li>-The speaker cables have been incorrectly connected or damaged.</li> <li>-The speakers are defective.</li> </ul>
High buzzing.	<ul style="list-style-type: none"> <li>-The audio input cables have been incorrectly connected or damaged.</li> </ul>
Weak bass and poor stereo perspective	<ul style="list-style-type: none"> <li>-The speaker connection is out of phase. Check that the positive and negative poles have been correctly connected, both at the back of the amplifier and at the back of the speaker.</li> </ul>
Distortion of sound.	<ul style="list-style-type: none"> <li>-Some of the conductor wires of the speaker cable are in contact with each other which causes distortion.</li> <li>-The volume is set too high.</li> <li>-The amplifier is defective and should be serviced by a qualified technician.</li> </ul>
The unit does not switch between inputs	<ul style="list-style-type: none"> <li>-The amplifier is defective and should be serviced by a qualified authorized service.</li> </ul>

# TECHNICAL DATA

Rated power output:	75W per channel / 4 ohms at THD 1% 60W per channel / 4 ohms at THD 0,015 and 20Hz-20kHz 45W per channel / 8 ohms at THD 1% 35W per channel / 8 ohms at THD 0,015 and 20Hz-20kHz
Dynamic peak power:	135W per channel / 4 ohms 80W per channel / 8 ohms
Frequency response:	2Hz - 200kHz (-3dB) at 15W 2Hz - 100kHz (-3dB) at maximum power
Signal-to-noise ratio:	>90dB at 1W >105dB at 60W
Voltage and power consumption:	AC220-240V / 50Hz
Dimensions (WxDxH):	440 x 330 x 85mm
Weight:	11,6Kg

*We reserve the right to change the technical data and the design of the product without notice as a result of further development.*

---

## CONSUMER NOTICE:

The System Fidelity product you have purchased is subject to Directive 2002/96/EC of the European Parliament and the Council of the European Union on waste electrical and electronic equipment (WEEE) and, in jurisdictions adopting that Directive, is marked as being put on the market after August 13, 2005, and should not be disposed of as unsorted municipal waste. Please utilize your local WEEE collection facilities in the disposition of this product and otherwise observe all applicable requirements.





For further informations please visit our web site  
[www.systemfidelity.com](http://www.systemfidelity.com)